

# Galaxy (Patented)

## Floor Machine



The Galaxy, a durable, powerful floor machine in an economical package, is precision-balanced for easy operation and maneuverability.

- Durable, heavy-duty chrome-plated base and handle for extended life.
- Ergonomic handle adjustment lever provides a comfortable custom fit without stooping or bending.
- Power cord instantly uncoils when handle adjustment lever is released.
- Convenient storage peg for brush or pad driver when not in use.
- Patented two-piece design for ease of shipping. Out-of-box assembly is a simple five-bolt operation.
- For safety, the mechanical lock-out on the handle must be released before the switch lever will activate.
- Powerful 1 HP and 1.5 HP models available in 17 inch and 20 inch widths.

**NSS® Enterprises, Inc.**  
3115 Frenchmens Road  
Toledo, Ohio 43607-2958  
USA  
[www.nss.com](http://www.nss.com)



# Galaxy Specifications

Pad Speed	175 RPM		Cord -120V. -240V.	50 ft. (15.2 m) 14-3 ST 50 ft. (15.2 m) 16-3 ST	
Pad Size	17 in. (43 cm) or 20 in. (51 cm)				
Motor -HP -Size -Voltage	1 HP or 1.5 HP 66 frame 110-120V. 220-240V. available		Weight -1 HP -1.5 HP	97 lbs. (44 kg) 100 lbs. (45.4 kg)	
Current -1 HP -1.5 HP	12.6 amps @ 120V.	6.3 amps @ 240V.		Shipping Weight -1 HP -1.5 HP	Handle-37 lbs.(16.8 kg) Base-70 lbs.(32 kg) Handle-37 lbs.(16.8 kg) Base-79 lbs.(36 kg)
Gears -1 HP -1.5 HP	2-idler planetary 3-idler planetary		Pallet Weight -1 HP -1.5 HP		Pallet (6) - 677 lbs. (307.1 kg) Pallet (6) - 731 lbs. (331.6 kg)
Sound Level	57.5 dBA			Shipping Class	70
			Warranty	3 year parts, 1 year labor	
Productivity — Measured in square feet per hour. (Floor coverage figures taken from the <i>ISSA 447 Cleaning Times</i> .)					
	Scrub	Polish	Spray Buff	Bonnet Clean	Shampoo
Galaxy 17"	1,923	2,000	1,724	1,111	1,000
Galaxy 20"	2,222	2,381	2,000	1,270	1,033

**1** A mechanical lock-out on the handle must be released before the switch lever can be activated. This important safety feature prevents accidental operation.

**2** The Galaxy is available with a 1 or 1.5 HP, 66-frame motor and a straight line planetary gear system, assuring efficient transfer of power from the motor to the brush.

**3** The Galaxy is shipped in two pieces. The handle and base can be assembled in minutes by sliding the two pieces together and installing five bolts (patented).

**4** The 360-degree base bumper protects furniture and fixtures from accidental run-ins.

**7** The ergonomically-designed handle adjustment lever is located near the control handle. Releasing this lever also automatically uncoils the power cord.

**6** The pad driver or brush can be placed on this convenient storage peg when the machine is not being used.

**5** Offset transport wheels make the Galaxy a breeze to take anywhere needed.

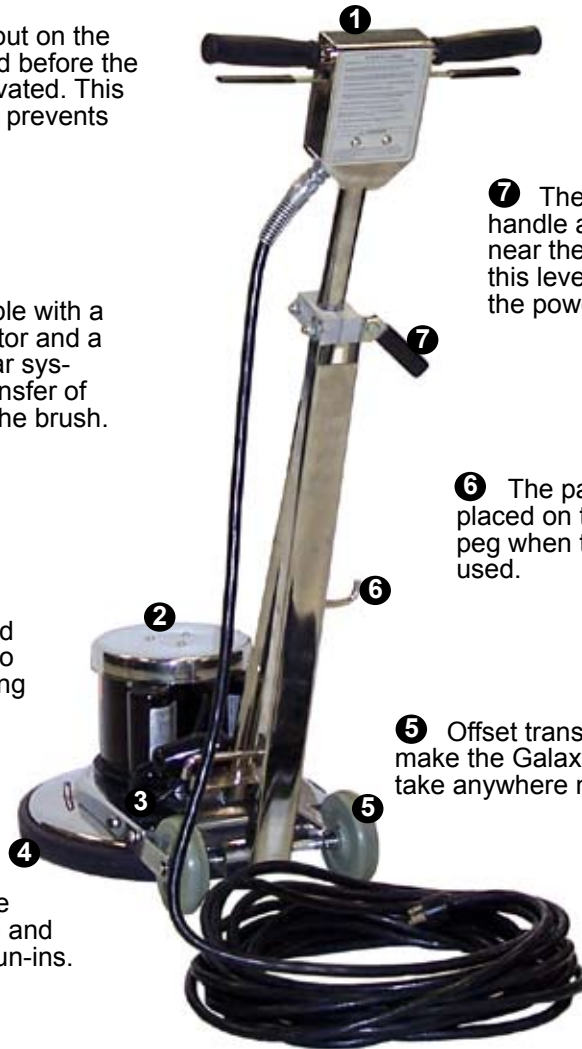

**NSS® Enterprises, Inc.**  
3115 Frenchmens Road  
Toledo, Ohio 43607-2958 USA  
419/531-2121 or 800/ 677-1663  
Fax 419/531-3761  
[www.nss.com](http://www.nss.com)  
[mailus@nss.com](mailto:mailus@nss.com)  
Specifications and appearance  
subject to change without notice.

DISTRIBUTED BY